

Instructions for use

Plate lifting clamps should be inspected before use to ensure that:

- all markings are legible;
- plate lifting clamps are free from nicks, gouges and cracks;
- a clamp with the correct Working Load Limit has been selected with respect to the load to be lifted;
- always make sure that the clamp is supporting the load correctly;
- the WLL should be applied in a straight pull and overloads are not permitted;
- clamps may not be heat treated as this may affect their Working Load Limit;
- never repair or reshape a clamp by welding, heating or bending as this may affect the Working Load Limit.

It is required that the products are regularly inspected and that the inspection should take place in accordance with the safety standards given in the country of use. This is required because the products in use may be affected by wear, misuse, overloading etc. with a consequence of deformation and alteration of the material structure.

Inspection should take place at least every six months and even more frequently when the clamps are used in severe operating conditions.

E - ES

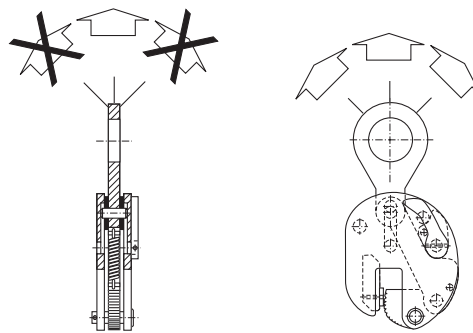

Plate lifting clamps type E and ES.
Do not side load the lifting eye.

EU - EUS

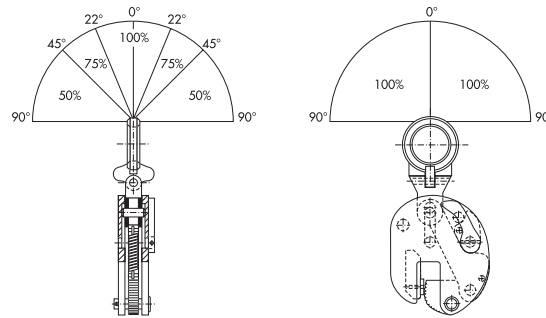

Plate lifting clamps type EU and EUS.
Load reduction should be applied as per load direction angle and corresponding remaining percentage of the Working Load Limit.

EH - EHS 100% WLL

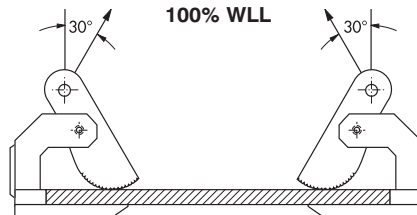

Plate lifting clamps type EH and EHS.
Full load may be applied up to a load direction angle of maximum 30°. Do not use larger angles.

1

2

3

4

5

6

7

8

9

10

11

12

13

14

15

16



P-6615

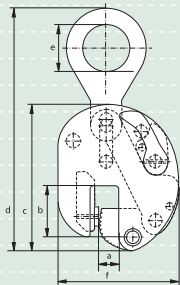

Green Pin® plate lifting clamp, type E for lifting and vertical transportation

- **Material** : carbon and alloy steel
- **Safety factor** : MBL equals 5 x WLL
- **Finish** : painted
- **Certification** : manufacturer's certificate including serial number
test certificates can be supplied upon request

type	working load limit tons	width opening	length opening	length	length	diameter inside eye	width	thickness	weight per pce
		a mm	b mm	c mm	d mm	e mm	f mm	g mm	kg
0.75 E	0.75	0 - 14	45	115	210	30	104	36	1.5
1 E	1	0 - 22	72	200	337	57	170	44	6
1.5 E	1.5	0 - 22	72	200	337	57	170	52	7.1
2 E	2	0 - 28	87	237	430	70	218	65	13.2
3 E	3	0 - 28	87	237	430	70	218	77	14.2
4 E	4	0 - 32	115	293	500	86	226	69	21
6 E	6	0 - 32	115	293	500	86	226	85	24.2
7.5 E	7.5	0 - 42	120	350	560	80	305	90	35
9 E	9	0 - 52	125	380	620	88	274	90	48
12 E	12	0 - 75	135	480	760	90	410	130	90
15 E	15	0 - 75	135	480	760	90	410	130	90
20 E	20	0 - 75	160	550	890	100	490	140	132



P-6616

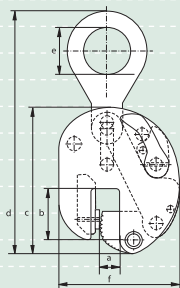

Green Pin® plate lifting clamp, type ES for lifting and vertical transportation

- **Material** : carbon and alloy steel
- **Safety factor** : MBL equals 5 x WLL
- **Finish** : painted
- **Certification** : manufacturer's certificate including serial number
test certificates can be supplied upon request

type	working load limit tons	width opening	length opening	length	length	diameter inside eye	width	thickness	weight per pce
		a mm	b mm	c mm	d mm	e mm	f mm	g mm	kg
0.75 ES	0.75	12 - 24	45	115	210	30	114	36	1.5
1 ES	1	18 - 38	72	200	337	57	186	44	6
1.5 ES	1.5	18 - 38	72	200	337	57	186	52	7.1
2 ES	2	23 - 50	87	237	430	70	240	65	13.2
3 ES	3	23 - 50	87	237	430	70	240	77	14.2
4 ES	4	26 - 58	115	293	500	86	252	69	21
6 ES	6	26 - 58	115	293	500	86	252	85	24.2
7.5 ES	7.5	30 - 72	120	350	560	80	335	90	35
9 ES	9	48 - 100	125	380	620	88	274	90	48
12 ES	12	75 - 150	135	480	760	90	485	130	90
15 ES	15	75 - 150	135	480	760	90	485	130	94
20 ES	20	75 - 150	160	550	890	100	565	140	132



P-6625

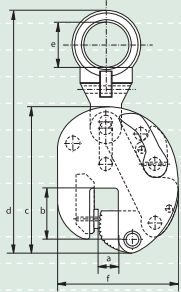

Green Pin® plate lifting clamp, type EU for lifting and transportation in all directions

- **Material** : carbon and alloy steel
- **Safety factor** : MBL equals 5 x WLL
- **Finish** : painted
- **Certification** : manufacturer's certificate including serial number
test certificates can be supplied upon request

type	working load limit	width opening	length opening	length	length	diameter inside eye	width	thickness	weight per pce
		a mm	b mm	c mm	d mm	e mm	f mm	g mm	kg
0.75 EU	0.75	0 - 14	45	115	220	31	104	36	1.6
1.5 EU	1.5	0 - 22	72	200	327	68	170	52	7.9
3 EU	3	0 - 28	87	237	450	80	218	77	15.2
6 EU	6	0 - 32	115	293	480	80	226	85	26
7.5 EU	7.5	0 - 42	120	350	580	80	305	90	35
9 EU	9	0 - 52	125	380	700	90	274	90	52
12 EU	12	0 - 75	135	480	780	115	410	130	94



P-6626

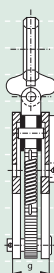
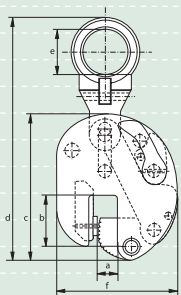

Green Pin® plate lifting clamp, type EUS for lifting and transportation in all directions

- **Material** : carbon and alloy steel
- **Safety factor** : MBL equals 5 x WLL
- **Finish** : painted
- **Certification** : manufacturer's certificate including serial number
test certificates can be supplied upon request

type	working load limit	width opening	length opening	length	length	diameter inside eye	width	thickness	weight per pce
		a mm	b mm	c mm	d mm	e mm	f mm	g mm	kg
0.75 EUS	0.75	12 - 24	45	115	220	31	114	36	1.6
1.5 EUS	1.50	18 - 38	72	200	327	68	186	52	7.9
3 EUS	3	23 - 50	87	237	430	80	240	78	15
6 EUS	6	26 - 58	115	293	480	80	252	95	26
7.5 EUS	7.5	30 - 72	120	350	580	80	335	100	35
9 EUS	9	48 - 100	125	380	700	90	384	100	52
12 EUS	12	75 - 150	135	480	780	115	485	140	94

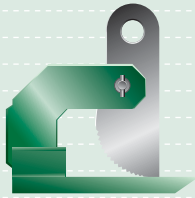

P-6635

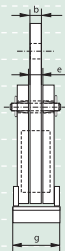
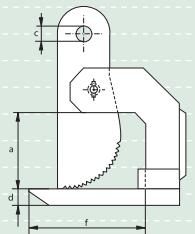

Green Pin® plate lifting clamp, type EH for lifting and horizontal transportation

- **Material** : carbon and alloy steel
- **Safety factor** : MBL equals 5 x WLL
- **Finish** : painted
- **Certification** : manufacturer's certificate including serial number
test certificates can be supplied upon request

type	working load limit per set	width opening		thickness	diameter eye	thickness	width	length	width	weight per set
		a mm	b mm	c mm	d mm	e mm	f mm	g mm	kg	
1.5 EH	1.5	0 - 22	18	16.2	12	16	70	60	4	
3 EH	3	0 - 60	16	23	25	18	155	80	11	
4 EH	4	0 - 60	20	42	25	22	155	80	16.4	
6 EH	6	0 - 60	20	42	25	22	155	100	17.8	
8 EH	8	0 - 60	25	42	25	27	155	120	20	
10 EH	10	0 - 60	25	42	30	27	155	120	28	
14 EH	14	0 - 60	30	48	35	32	155	130	36	
18 EH	18	0 - 60	30	48	40	32	155	150	48.2	

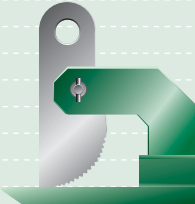

P-6636

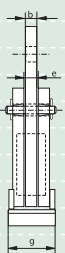
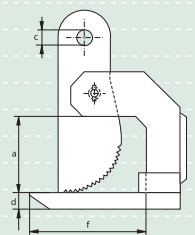

Green Pin® plate lifting clamp, type EHS for lifting and horizontal transportation

- **Material** : carbon and alloy steel
- **Safety factor** : MBL equals 5 x WLL
- **Finish** : painted
- **Certification** : manufacturer's certificate including serial number
test certificates can be supplied upon request

type	working load limit per set	width opening		thickness	diameter eye	thickness	width	length	width	weight per set
		a mm	b mm	c mm	d mm	e mm	f mm	g mm	kg	
3 EHS	3	0 - 100	16	23	25	18	155	80	12.4	
4 EHS	4	0 - 100	20	42	25	22	155	80	17.6	
6 EHS	6	0 - 100	20	42	25	22	155	100	20	
8 EHS	8	0 - 100	25	42	25	27	155	120	26	
10 EHS	10	0 - 100	25	42	30	27	155	120	32	
14 EHS	14	0 - 100	30	48	40	32	155	130	40	
18 EHS	18	0 - 100	30	48	40	32	155	150	52	

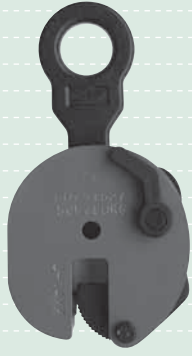

Applications

Plate lifting clamps are used for lifting and transportation of all kinds of steel plates and beams.

Range

Van Beest offers a wide range of lifting clamps for horizontal and/or vertical lifting of steel plates and beams ranging from Working Load Limit 750 kg up to 20.000 kg. The steel plates may have a thickness up to 150 mm. Upon request other types of clamps can be manufactured.

Design

Four different designs have been developed:

- type E for lifting and vertical transportation of steel plates;
- type EH for horizontal transportation of steel plates;
- type EU a universal type for transportation in all directions;
- type ESV for transportation of steel beams.

Type E, EH and EU are also available as ES, EHS and EUS versions, which means that these versions have an increased opening.

All types of lifting clamps carry the following markings:

- Working Load Limit;
- manufacturer's identification symbol (VBS);
- traceability code;
- jaw opening;
- CE;
- serialnumber.

Finish

The plate lifting clamps are made of carbon and alloy steel and are painted green to be recognized as a Green Pin® product.

Certification

All plate lifting clamps are supplied with a serial number and a manufacturer's certificate. Test certificates can be supplied upon request.

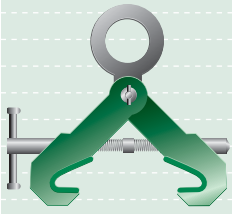

P-6685

Green Pin® lifting clamp, type ESV for lifting and transportation of steel beams

- **Material** : carbon and alloy steel
- **Safety factor** : MBL equals 5 x WLL
- **Finish** : painted
- **Certification** : manufacturer's certificate including serial number
test certificates can be supplied upon request

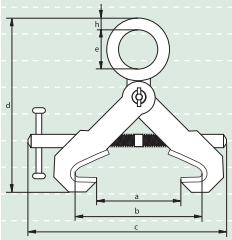

type	working load limit tons	width jaw opening	width jaw opening	length c mm	height d mm	diameter eye inside e mm	width f mm	thickness g mm	width h mm	weight per pce kg
		a mm	b mm							
2 ESV	2	0 - 160	60 - 200	270	210 - 250	65	120	16	22	5.1
3 ESV	3	0 - 160	60 - 200	270	250 - 290	65	120	16	22	5.3
4 ESV	4	0 - 250	80 - 310	400	285 - 370	70	125	20	28	8.6
5 ESV	5	0 - 260	90 - 320	400	355 - 445	80	125	20	36	11.1
6 ESV	6	0 - 340	85 - 420	480	360 - 510	80	125	20	36	14

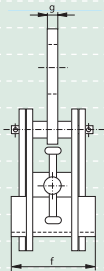

Green Pin® plate lifting clamp spare parts



P-6651 lifting eye



P-6652 lock lever assembly



S-6653 lock spring



P-6654 cam assembly



S-6655 cam pin



S-6656 pivot



S-6657 eye pin



P-6658 universal eye component